

## **Exhaust Cat-Back 2009-2013 GM 1500**

(117030020, 117030030, 117033030)

### ***Installation Guide***





## **DISCLAIMER OF LIABILITY**

Performance products can increase horsepower above and beyond factory specifications. Additional horsepower creates more stress on the drive-train components, which could result in drive-train failure.

Note regarding emissions-related, non-E.O.-legal products: THESE PRODUCTS ARE LEGAL IN CALIFORNIA ONLY FOR RACING VEHICLES THAT MAY NEVER BE USED, OR REGISTERED OR LICENSED FOR HIGHWAY OR OFF-ROAD USE.

This agreement sets forth the terms and conditions for the use of PPE products. The installation of this product indicates that the Buyer has read and understands this agreement and accepts the terms and conditions. PPE (Pacific Performance Engineering) Inc., its distributors, employees, and dealers (the "Seller") shall not be responsible for the product's proper use and service. The buyer hereby waives all liability claims. The Buyer hereby acknowledges no reliance on the Seller's skill or judgment to select or furnish goods suitable for any particular purpose and that there are no liabilities which extend beyond the description on the face hereof, and the Buyer hereby waives all remedies or liabilities expressed or implied, arising by law or otherwise (including without any obligation of the Seller with respect to fitness, merchantability and consequential damages), or whether or not occasioned by the Seller's negligence. The Seller disclaims any warranty and expressly disclaims any liability for personal injury or damages. The Buyer acknowledges and agrees that the disclaimer of any liability for personal injury is a material term for this agreement and the Buyer agrees to indemnify the Seller and to hold the Seller harmless from any claim related to the item of equipment purchased. Under no circumstances will the Seller be liable for any damages or expenses by reason of use or sale of any such equipment. The Seller assumes no liability regarding the improper installation or misapplication of its products. It is the installer's responsibility to check for proper installation and if in doubt, contact the manufacturer. The Buyer is solely responsible for all warranty issues from the manufacturer.

## **LIMITATION OF WARRANTY**

The Seller gives Limited Warranty as to description, quality, merchantability, and fitness for a particular purpose, productiveness, or any other matter of Seller's product sold herewith. The Seller shall not be responsible for the products proper use and service and the Buyer hereby waives all rights other than those expressly written herein. This warranty shall not be extended, altered or varied except by a written instrument signed by Seller and Buyer. The Warranty on PPE Manifolds and Up-Pipes Kits, OEM-Length Up-Pipes is three (3) years, a limited lifetime warranty on PPE cast aluminum pans and covers, and a limited lifetime warranty on PPE Transmission Coolers and one (1) year limited warranty on all other PPE products from the date of sale to original buyer and limited solely to the parts contained within the products kit. All products that are in question of Warranty must be returned prepaid to the Seller and must be accompanied by a dated proof of purchase receipt. All Warranty claims are subject to approval by Seller. Under no circumstances will the Seller be liable for any labor charged or travel time incurred in diagnosis for defects, removal, or re-installation - of this product or any other contingent expenses. Under no circumstances will the Seller be liable for any damage or expenses incurred by reason of the use or sale of any such equipment. In the event that the buyer does not agree with this agreement: the buyer may promptly return this product, in a new and unused condition in its original packaging, with a dated proof of purchase to the place of purchase within ten (10) days from date of purchase for a full refund. The installation of this product indicates that the buyer has read and understands this agreement and accepts its terms and conditions.



## CONTENTS

- 1 *Inlet Pipe*
- 2 *3.0" Stainless Steel Hanger Clamp (1)*
- 3 *3.0" Stainless Steel Clamps (2)*
- 4 *Extension*
- 5 *Muffler*
- 6 *2.5" Stainless Steel Clamps (5)*
- 7 *Passenger Side Front Tailpipe*
- 8 *Passenger Side Exit Pipe*
- 9 *Driver Side Front Tailpipe*
- 10 *Driver Side Rear Tailpipe*
- 11 *Driver Side Exit Pipe*
- 12 *Exhaust Tips (2)*
- 13 *3/8" - 16 x 1.25" Bolt*
- 14 *3/8" Flat Washer*
- 15 *3/8" Lock Washer*
- 16 *3/8" - 16 Z Nut*
- 17 *Backing Plates (2)*
- 18 *Zip Tie*
- 19 *Lock Washers (6)*
- 20 *Rubber Hanger*
- 21 *Left Frame Hanger*

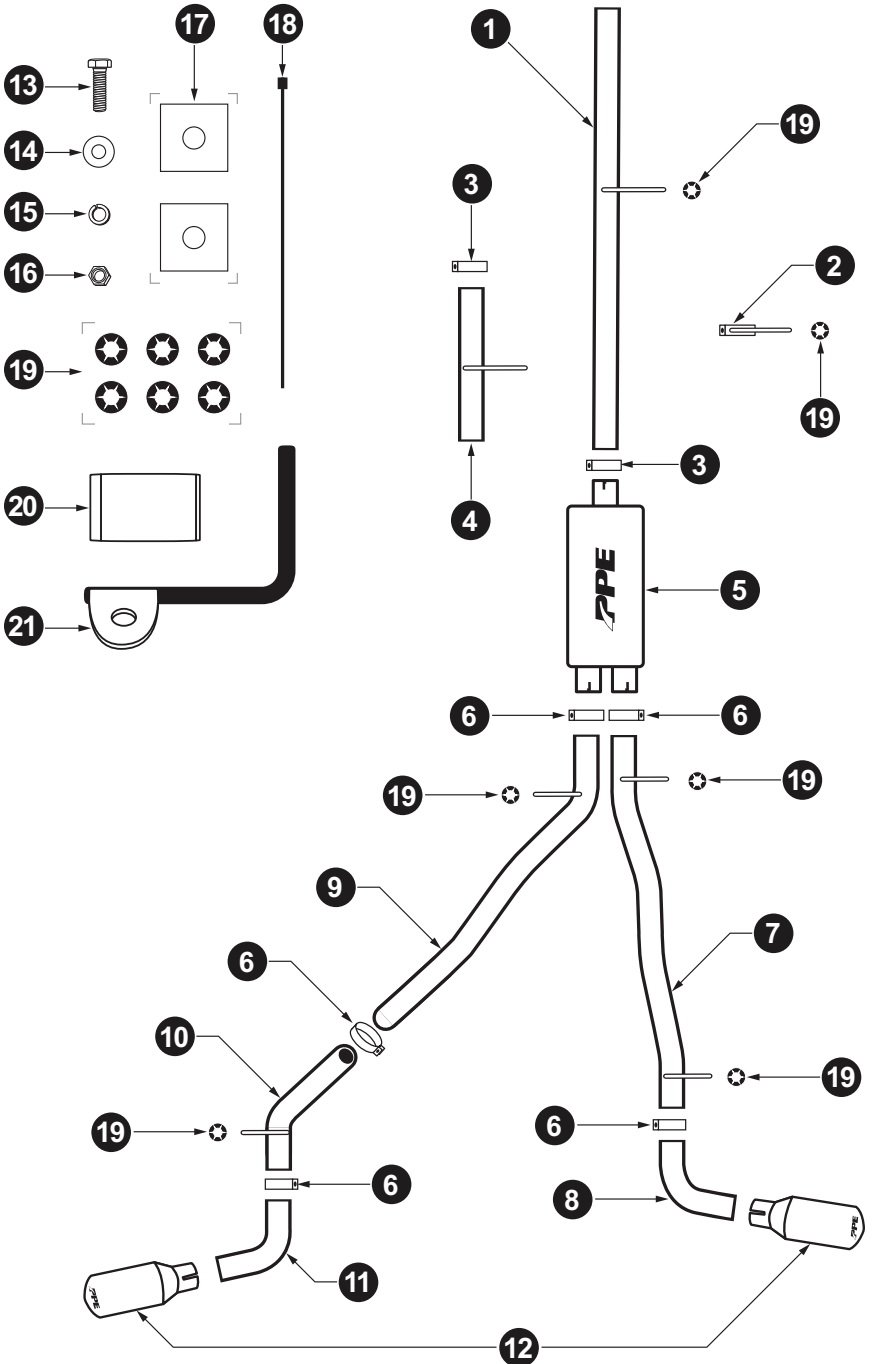

## REMOVAL

- Step 1** Vehicle off. Raise vehicle on hoist or rack.
- Step 2** Apply penetrating lubricant to the stock rubber hanger mounts and clamp flange bolts, for easier removal.
- Step 3** Cut tailpipe just behind stock muffler outlet. Disconnect hangers from rubber isolators and remove cut tailpipe section.
- Step 4** Remove ball clamp. Set ball clamp aside for later installation. Disconnect hangers from rubber isolators. Remove muffler section. It is recommended to have help removing stock exhaust.

## PREPARATION

- Step 1.** Remove nuts from each of the PPE Stainless Steel Clamps (2, 3, 6). Apply anti-seize to each bolt. Reassemble Clamps.
- Step 2** Refer to chart below for the proper assembly combination that relates to your specific vehicle.

WHEEL BASE	BODY STYLE	BED LENGTH	ASSEMBLY
143 1/2"	Extended Cab	6'5"	Don't install extension
143 1/2"	Crew Cab	5'5"	Don't install extension
157 1/2"	Extended Cab	8'	Install extension

**NOTE:** Every slip-fit connection in this kit must seat 3" deep. Mark related components accordingly so your PPE exhaust system fits properly onto your vehicle.

## INSTALLATION

- Step 1** Place ball clamp (removed step 4) onto inlet pipe (1), then connect it to catalytic converter. Insert hanger into rubber isolator. Tighten clamp to secure but leave loose for now.

**NOTE:** Some early 2009 models, the rubber hanger mount is welded further rearward on frame. In this case, install 3.0" Stainless Steel Hanger Clamp (2) onto inlet pipe. tighten, then insert hanger into rubber isolator.

- Step 2** Place 3.0" Stainless Steel Clamp (3) on muffler (5) inlet then connect muffler to inlet/extension pipe (1 / 4). Place 2, 2.5" Stainless Steel Clamps (6) onto muffler outlets. Tighten clamps to secure but leave loose for now.



- Step 3** *Fasten Left Frame Hanger (21) to vehicle using bolt (13), Backing Plates (17), 3/8" Flat Washer (14), Lock Washer (15) and 3/8" - 16 Z Nut (16). Then hang Rubber Hanger (20) on Frame Hanger (21) end.*
- Step 4** *Route Passenger Side Front Tailpipe (7) over rear axle then connect to muffler outlet. Insert hangers into rubber isolators then tighten 2.5" Stainless Steel Clamp (6). Tighten clamp to secure but leave loose for now.*
- Step 5** *Route Driver Side Front Tailpipe (9) over rear axle then connect to muffler outlet. Insert hanger into rubber isolator then tighten 2.5" Stainless Steel Clamp (6). Tighten clamp to secure but leave loose for now.*
- Step 6** *Fit 2.5" Stainless Steel Clamp (6) over Passenger Side Front Tailpipe (7) Tighten to secure but leave loose for now.*
- Step 7** *Fit 2.5" Stainless Steel Clamp (6) over end of Driver Side Front Tailpipe (10) and install on to Driver Side Front Tailpipe (9). Insert hanger into rubber isolator then tighten 2.5" Stainless Steel Clamp (6). Tighten clamp to secure but leave loose for now.*
- Step 8** *Fit 2.5" Stainless Steel Clamps (6) over ends of Passenger Side Front Tailpipe (7) and Driver Side Rear Tailpipe (10). Install Passenger Side Exit Pipe (8) and Driver Side Exit Pipe (11). Tighten clamps to secure but leave loose for now.*
- Step 11** *Adjust the position of each exhaust component to completely clear other vehicle components and ensure suspension travel will not contact any part of the exhaust.*
- Step 12** *Tighten all exhaust components beginning with the Inlet Pipe (1) and working your way towards the Driver and Passenger Side Exit Pipes (8, 11). Adjust for clearance as needed.*
- Step 13** *Install Exhaust Tips (12) on Driver and Passenger Side Exit Pipes (8, 11). Adjust placement to ensure they don't contact any other vehicle components. Tighten to secure.*
- Step 14** *Install the Hanger Locks (19) on hangers as indicated.*

*Installation complete.*



*PPEpower.com*  
*sales@PPEpower.com*  
*Phone: (714) 985-4825*